

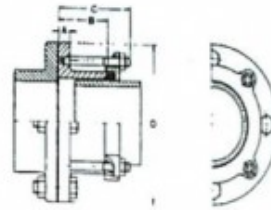

Flange Adaptors

for METRIC DUCTILE IRON PIPE
Flange Drilled to PN10 and PN16
98mm to 2082mm O.D.



NOM DIA	PIPE O.D	TABLE PN	A	B	C	D	PCD	BH		STUDS		APPROX WEIGHT
								NO	DIA	NO	DIA X L	
mm	mm		mm	mm	mm	mm	mm	mm		In X mm	Kg	
80	98	10,16	19	73	108	200	160	8	18	4	1/2 x 102	5.8
100	118	10,16	19	76	115	220	180	8	18	4	1/2 x 110	6.4
150	170	10,16	19	76	115	285	240	8	22	4	1/2 x 110	10.5
200	222	10	20	76	115	340	295	8	22	4	1/2 x 110	14.3
200	222	16	20	76	115	340	295	12	22	6	1/2 x 110	14.3
250	274	10	22	90	127	400	350	12	22	6	1/2 x 120	19.2
250	274	16	22	90	127	400	355	12	26	6	1/2 x 120	19.2
300	326	10	22	90	127	455	400	12	22	6	1/2 x 120	23
300	326	16	22	90	127	455	410	12	26	6	1/2 x 120	23
350	378	10	25	108	152	505	460	16	22	8	5/8 x 146	33
350	378	16	25	108	152	520	470	16	26	8	5/8 x 146	34.8
400	429	10	25	108	152	565	515	16	26	8	5/8 x 146	40
400	429	16	25	108	152	580	525	16	30	8	5/8 x 146	42.8
450	480	10	25	108	152	615	565	20	26	10	5/8 x 146	44.5
450	480	16	25	108	152	640	585	20	30	10	5/8 x 146	48
500	532	10	26	114	160	670	620	20	26	10	5/8 x 152	50
500	532	16	26	114	160	715	650	20	33	10	5/8 x 152	58



COUPLINGS

for DUCTILE IRON PIPE
up to 2082mm O.D.

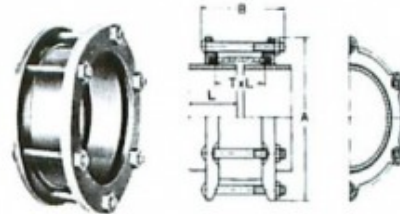

* Middle Ring of Ductile to BS 2789 Grade 420/12

NOM DIA	PIPE O.D	O.D TOL	L	A	B	SLEEVE		PLUGS NO	BOLTS		Max TEST PRESS	APPROX WEIGHT	
						T	L		NO	DIA X L			
mm	mm	in	mm	mm	mm	mm	mm	mm		In mm	bar	Kg	
*80	98	3.86	+2.1/-2.6	100	178	168	7.1	102	1	4	1/2x160	70	4.7
80	98	3.86	+2.1/-2.6	100	178	168	6.4	102	1	4	1/2x160	70	4.5
*100	118	4.65	+2.1/-3.0	100	200	168	7.4	102	1	4	1/2x160	70	5.4
100	118	4.65	+2.2/-3.0	100	200	168	6.4	102	1	4	1/2x160	70	5.2
*150	170	6.69	+2.3/-3.0	100	262	173	7.6	102	1	4	1/2x165	60	8.8
150	170	6.69	+2.3/-3.0	100	262	173	6.4	102	1	4	1/2x165	60	8.6
*200	222	8.74	+2.4/-3.5	100	314	173	7.6	102	1	6	1/2x165	58	11.7
200	222	8.74	+2.4/-3.5	100	314	173	6.4	102	1	6	1/2x165	58	11.5
*250	274	10.79	+2.5/-3.5	100	368	173	8.0	102	2	6	1/2x165	50	17.2
250	274	10.79	+2.5/-3.5	100	368	173	6.4	102	2	6	1/2x165	50	16.5
*300	326	12.83	+2.6/-3.5	100	420	173	8.5	102	2	6	1/2x165	50	18.5
300	326	12.83	+2.6/-3.5	100	420	173	6.4	102	2	6	1/2x165	44	17.8
350	378	14.88	+2.7/-3.5	125	488	252	9.5	152	2	8	5/8x240	40	27.5
400	429	16.89	+2.8/-4.0	125	539	252	9.5	152	2	8	5/8x240	38	32
450	480	18.89	+2.9/-4.0	125	590	252	9.5	152	3	10	5/8x240	35	37.8
500	532	20.94	+3.0/-4.0	125	642	252	9.5	152	3	10	5/8x240	35	420